

National Council of Science Museums, Kolkata

TENDER

Tender No: I-18012/7/20(126)

**Name of the work: Supply, Installation, Integration, Testing, Commissioning and Three Years Onsite Maintenance of
“Digital & Immersive Experience in the Reception Hall and Other Areas” at National Museum, New Delhi.**

Corrigendum- 2

SI No	Reference	Original Clause	Modified Clause
1.	Page 43, Annexure I(b) Item -1	Contrast: 4000:1 or greater in normal mode	Contrast: 4000:1 or greater for VA Panel technology and 1300:1 or greater for IPS Panel Technology in normal mode
2.	Page 49, Annexure – I-(c) Item 1	Display Wall Dimension 11 X 12 ft (approx.)	Display Wall Dimension 11 (width) X 12 (height) ft (approx.) The width may be altered +/- 1 feet. The SI should visit the site for the actual dimension and planning.
		Resolution 4 K (Minimum)	Resolution as per P2.5 Refresh rate >=3000 Hz
		Contrast Ratio 5000:1	Contrast Ratio 3000(or higher) : 1
		Power consumption 5400 watts max. or less Power Consumption 2500 Watt for the video wall	Power consumption of video wall 8500 watts or Less
		Brightness: 1200 NIT or higher	Brightness: 600 NIT (minimum per module) or higher
3.	Reference drawing for the site	-	The Floor Plan of NATIONAL MUSEUM is given in Page 2. The drawing may not be in scale. Bidder may visit the site to verify the site.
4.	Tentative Module Diagram with Power / Network Distribution	-	The NM system architecture Module diagram is given in Page 3. The tentative diagram for the network and power distribution for CCC.

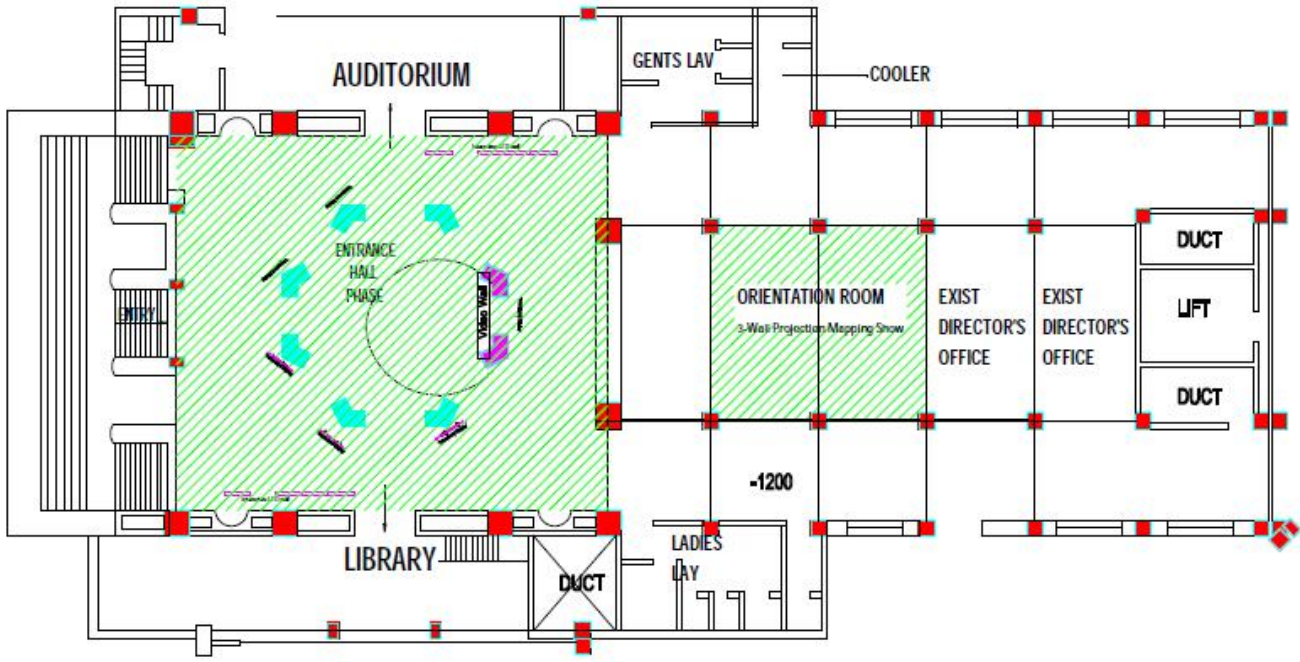

Tentative Module Diagram with Power / Network Distribution

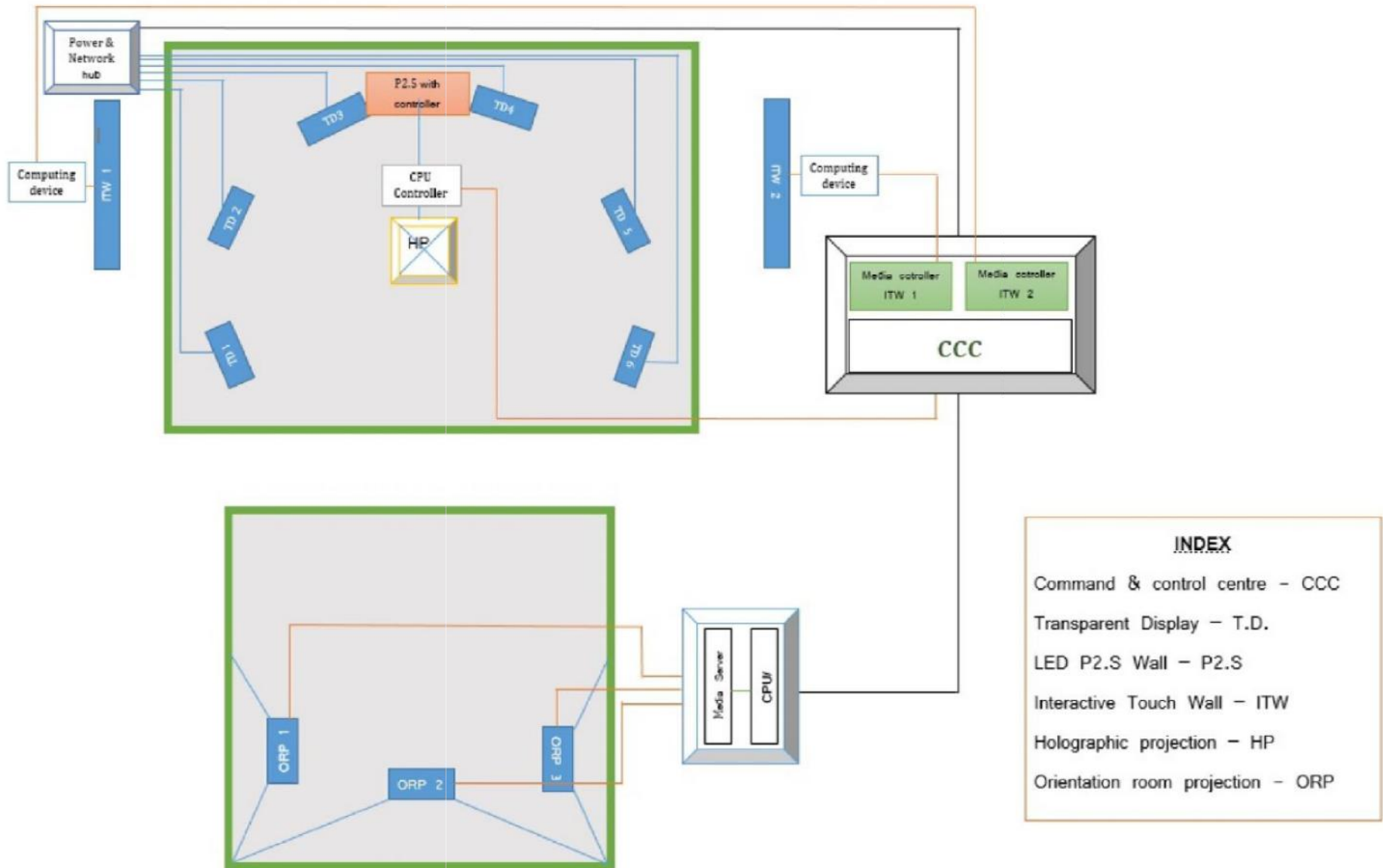

INDEX

- Command & control centre - CCC
- Transparent Display - T.D.
- LED P2.S Wall - P2.S
- Interactive Touch Wall - ITW
- Holographic projection - HP
- Orientation room projection - ORP